

A blue plastic EZ Reach sponge sampler with a white sponge tip, set against a background of a petri dish with bacterial colonies.

EZ Reach[™]

Sponge Samplers

For Environmental Monitoring

world
bioproducts

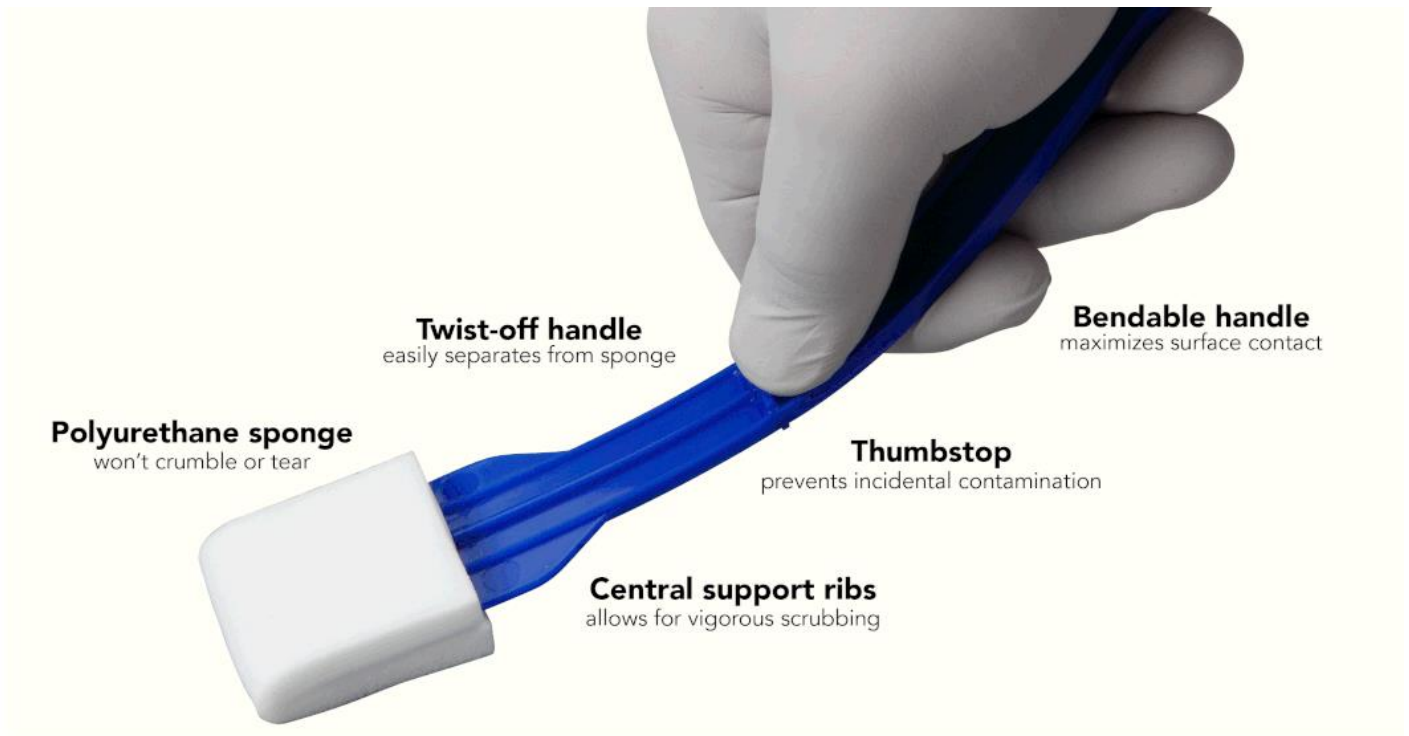

Beyond Basic Sample Collection

Environmental monitoring requires collecting samples from a wide variety of surfaces, from processing equipment and conveyors, to drains and expansive floor or wall surfaces. The EZ Reach™ sponge sampler family offers a range of sizes and functions to fit most sampling needs. Each device has a high purity polyurethane sponge with our patented twist-off handle.



US Patent 8,127,627 B2



Polyurethane Sponge

A biocide-free, medical grade material that resists tearing and flaking, and won't inhibit the growth of microorganisms or interfere with downstream diagnostic tests.

HiCap™ Neutralizing Broth

An advance sample collection solution designed specifically for food safety, that improves the recovery of microorganism from surfaces and unlike other collection solutions, it maintains the viability of stressed and injured cells for up to 72 hours after collection.

Choose the Right Device

Match the sponge to the application

All samplers are available dry or pre-hydrated with various collection solutions.



split **SAMPLES**

EZ Reach™ Split-Sampler

Easily separate a single sample into two distinct samples without risking incidental contamination or compromising sensitivity.

or pick a **SIZE**



EZ Reach™

sample surface areas
up to 2 ft²



EZ Reach™ 4X

sample surface areas
up to 8 ft²



EZ Reach™ 8X

sample surface areas
up to 16 ft²

Collection Devices are just the beginning

Streamline sample collection and processing

Adapters & Extension Poles

Lose the ladder and safely collect samples from hard to reach areas with telescoping extension poles and specialized adapters made exclusively for EZ Reach™ sponges and PUR-Blue™ swabs. Extension poles are available in 4, 8, and 12 ft.



Dividable Grid Containers

Safely and efficiently move samples around the laboratory. Reconfigurable dividers provide clear separation of samples, allowing for easy handling and processing while minimizing the risk of cross contamination.



Online Resource Library

Learn how to improve the effectiveness of your environmental monitoring programs. Visit our online Education Library to download white papers and studies, or view recorded presentations detailing the efficacy and advantages of HiCap Neutralizing Broth.

worldbioproducts.com/education

www.worldbioproducts.com
orders@worldbioproducts.net
PO Box 947, Bothell, WA 98041-0947
(877) 260-6441

WBMKT_BROEZEN2102



HiCap™ Neutralizing Broth

Comparison Study Summary



worldbioproducts.com



Unexpected Delays?

HiCap™ Neutralizing Broth

protects your samples for up to 72 hours

While it's ideal to test samples within 24 hours of collection, there are times when that is just not possible. With HiCap Neutralizing Broth, **environmental samples can be held up to 72 hours** before starting enrichments, without sacrificing accuracy. Unlike other collection solutions, HiCap Neutralizing Broth has the ability to **maintain the viability of stressed and injured cells** for up to 72 hours after collection.



Comparison Study Summary

Method

Overnight cultures of *Listeria monocytogenes* (ATCC 19118) or *Salmonella typhimurium* (ATCC 14028) were inoculated onto 1 ft² stainless steel coupons and dried under ambient conditions for 72 hours. After drying, the coupons were sampled with EZ Reach™ sponge samplers hydrated with 10 ml of HiCap™ Neutralizing Broth, Lethen Broth, Neutralizing Buffer, or D/E Neutralizing Broth. For comparison, sponges were either enriched immediately or held at refrigerated temperatures for 72 hours and then enriched. *Listeria* samples were enriched in 100 ml UVM broth, transferred to Demi Fraser Broth and streaked to Harlequin® *Listeria* Chromogenic Agar to determine presence/absence of *Listeria*. *Salmonella* samples were enriched in 100 ml BPW, followed by RV broth and then streaked on XLD and Harlequin® *Salmonella* Chromogenic agar to determine presence/absence of *Salmonella*.

Results

Comparison of HiCap Neutralizing Broth with Neutralizing Buffer, D/E Neutralizing Broth, and Letheen Broth for the recovery of pathogens from stainless steel surfaces.

Neutralizing Buffer vs HiCap Neutralizing Broth

| Samples Enriched | Listeria | | Salmonella | |
|-----------------------|--|------------------------------|--|------------------------------|
| | Neutralizing Buffer (positive / tested) | HiCap (positive / tested) | Neutralizing Buffer (positive / tested) | HiCap (positive / tested) |
| 0 h after collection | 1/15 | 15/15 | 1/15 | 13/15 |
| 72 h after collection | 0/15 | 13/15 | 0/15 | 15/15 |

D/E Neutralizing Broth vs HiCap Neutralizing Broth

| Samples Enriched | Listeria | | Salmonella | |
|-----------------------|---|------------------------------|---|------------------------------|
| | D/E Neutralizing Broth (positive / tested) | HiCap (positive / tested) | D/E Neutralizing Broth (positive / tested) | HiCap (positive / tested) |
| 0 h after collection | 11/30 | 13/30 | 0/30 | 9/30 |
| 72 h after collection | 5/30 | 12/30 | 0/30 | 10/30 |

Letheen Broth vs HiCap Neutralizing Broth

| Samples Enriched | Listeria | | Salmonella | |
|-----------------------|--------------------------------------|------------------------------|--------------------------------------|------------------------------|
| | Letheen Broth (positive / tested) | HiCap (positive / tested) | Letheen Broth (positive / tested) | HiCap (positive / tested) |
| 0 h after collection | 9/15 | 12/15 | 14/30 | 11/30 |
| 72 h after collection | 5/15 | 12/15 | 10/30 | 10/30 |

Conclusions

In each comparison, HiCap Neutralizing Broth demonstrated equivalent or better recovery of the stressed Salmonella and Listeria organisms from samples enriched immediately after sampling when compared to the other commonly used collection solutions. However, while the other collection solutions demonstrated evidence of significant die-off of the target pathogens in samples held 72 hours prior to enrichment, these organisms remained viable in the HiCap Neutralizing Broth samples. With HiCap Neutralizing Broth recovery rates after 72 hours of refrigerated storage were comparable to the recovery rates of samples enriched immediately after collection.

HiCap™ Neutralizing Broth vs. Other Collection Solutions

HiCap Neutralizing Broth was developed to meet the specific needs of food and beverage producers. Unlike other collection solutions, HiCap Neutralizing Broth helps to ensure the accuracy of microbiological test results by neutralizing a comprehensive array of different sanitizers and greater quantity of residual sanitizer. HiCap Neutralizing Broth is formulated to be non-allergenic, contain only components acceptable or use in food, and to be compatible with both traditional and rapid enumeration and pathogen detection methods.

| | HiCap Neutralizing Broth | Neutralizing Buffer | Letteen Broth | D/E Neutralizing Broth |
|---|--------------------------|----------------------|----------------------|------------------------|
| Ability to neutralize quats ¹ | High | Moderate | Weak | High |
| Ability to neutralize free chlorine | High | Weak | Moderate | High |
| Ability to neutralize high acid | High | Weak | Moderate | High |
| Ability to neutralize peroxyacetic acid | High | Weak | Weak | High |
| Ability to buffer low pH (high acid) sanitizers ² | Yes | No | No | No |
| All components are compatible with 3M Petrifilm plates ³ | Yes | No | Yes | No |
| Compatible with molecular detection assays | Yes | No ⁴ | Yes | Yes |
| All components listed in EAFUS ⁵ as acceptable for use in food | Yes | No | Yes | No |
| All components are identified as non-allergenic | Yes | Unknown ⁶ | Unknown ⁷ | No ⁸ |
| No meat peptones or extracts | Yes ⁹ | Yes | No | No |
| Store at ambient temp 2-30°C | Yes | Yes | Yes ¹⁰ | No ¹¹ |

1) Technical data available upon request. 2) Technical data available upon request. 3) 3M recommends avoiding solutions that contain bisulfite, citrate and thiosulfate when working with Petrifilm. 4) Possibly due to the presence of aryl sulfonate complex in the neutralizing buffer. 5) EAFUS - Everything Added to Food in the U.S. (U.S. FDA). 6) Contains aryl sulfonate complex of unknown allergenicity. 7) Letteen broth contains lecithin. Lecithin used in microbiological culture media is typically derived from soy or egg. 8) Contains peptone from milk and lecithin, which is typically derived from soy or egg. 9) Includes vegetable peptones (not digested with animal-derived enzymes) and yeast extract. 10) Some suppliers of letheen broth specify refrigerated storage. 11) D/E shows pH instability with ambient storage.

3M and Petrifilm are trademarks of 3M, St. Paul, MN.
Patent Pending for HiCap Neutralizing Broth





Poultry & Carcass Sampling

For Sample Collection



Choose the Right Device

Match the tool to your application



Boot Swabs

Boot swabs are stretchable, sterile fabric boot covers with an integral elastic band designed to easily slide over any shoe or boot and remain securely in place for effortless collection of samples from the floor surface. Available pre-moistened with double-strength skim milk, boot swabs are packaged as singles or pairs in a completely sealed, non-perforated, sterile sample bag to ensure product integrity and quality.

Pull String Sampler

Pull-String samplers are designed for collecting samples from poultry and other livestock housing facilities. The 4" x 4" 12-ply cotton gauze pad with an attached string is available pre-moistened with double-strength skim milk, packaged in a completely sealed, non-perforated, sterile sample bag to ensure product integrity and quality.



Carcass Sampling Kit

The Carcass Sampling Kit contains all components (sponge, gloves, 100 cm² template, and 25 ml of Butterfield's phosphate buffer) needed to collect and transport 15 carcass samples according to the guidelines of the U.S. Pathogen Reduction Act. Kit components (sponges, gloves, template and buffer) can also be bought separately to better match your workflow.



SampleRight™ Sponge Sampler

The SampleRight™ Sponge Sampler with a high-density polyurethane sponge resists crumbling and flaking, making it ideal for carcass sampling. The sponge is easy to manipulate and hold while collecting samples. Available pre-hydrated with Buffered Peptone Water or dry, with or without gloves, to fit your carcass sampling needs.



EZ Reach™ Sponge Sampler

The EZ Reach™ Sponge Sampler with a patented twist-off handle eliminates the need to touch the sponge, reducing the risk of sample contamination and making it a great option for cattle, swine, or even turkey carcass sampling. Available dry, or pre-hydrated with Buffered Peptone water.

The EZ Reach™ 4X sponge sampler, hydrated with double strength skim milk is an excellent alternative for monitoring poultry breeding facilities and grow houses as well as hatcheries and egg laying operations.



US Patent 8,127,627 B2

Collection Devices are just the beginning

Streamline sample collection and processing

Adapters & Extension Poles

Lose the ladder and safely collect samples from hard to reach areas with telescoping extension poles and specialized adapters made exclusively for EZ Reach™ sponges and PUR-Blue™ swabs. Extension poles are available in 4, 8, and 12 ft.



Dividable Grid Containers

Safely and efficiently move samples around the laboratory. Reconfigurable dividers provide clear separation of samples, allowing for easy handling and processing while minimizing the risk of cross contamination.



Online Resource Library

Learn how to improve the effectiveness of your environmental monitoring programs. Visit our online Education Library to download white papers and studies, or view recorded presentations detailing the efficacy and advantages of HiCap Neutralizing Broth.

worldbioproducts.com/education

www.worldbioproducts.com
orders@worldbioproducts.net
PO Box 947, Bothell, WA 98041-0947
(877) 260-6441

WBMKT_2010



Upgrade to Polyurethane

PUR-polyurethane has several advantages over cellulose, including resistance to tearing, flaking or fraying, and improved release of organisms. It's synthetic manufacturing process yields a more consistent biocide-free material without any components that may interfere with downstream test methods. Request the free white paper to learn more.



Environmental Monitoring

Compare HiCap™ Neutralizing Broth to Traditional Collection Solutions

| HiCap Neutralizing Broth | Neutralizing Buffer | Lethen Broth | D/E Neutralizing Broth |
|---|----------------------|----------------------|------------------------|
| Quaternary ammonium neutralization ¹ | | | |
| High | Moderate | Weak | High |
| Free chlorine neutralization | | | |
| High | Weak | Moderate | High |
| Ability to buffer low pH (high acid) sanitizers | | | |
| High | Weak | Moderate | High |
| Peroxyacetic acid neutralization | | | |
| High | Weak | Weak | High |
| All components listed in EAFUS ² as acceptable for use in food | | | |
| Yes | No | Yes | No |
| All components compatible with 3M Petrifilm™ ³ | | | |
| Yes | No ⁴ | Yes | No |
| All components are identified as non-allergenic | | | |
| Yes | Unknown ⁵ | Unknown ⁶ | No ⁷ |
| Compatible with molecular detection assays | | | |
| Yes | No ⁸ | Yes | Yes |
| Stable with ambient storage | | | |
| Yes | Yes | Yes ⁹ | No ¹⁰ |

1. Technical data are available upon request. 2. EAFUS - Everything Added to Food in the U.S. (U. S. FDA) 3. 3M and Petrifilm are trademarks of 3M, St. Paul, MN 4. 3M recommends avoiding solutions that contain bisulfite, citrate and thiosulfate when working with Petrifilm 5. Contains aryl sulfonate complex of unknown allergenicity. 6. Lethen broth contains lecithin. Lecithin used in microbiological culture media is typically derived from soy or egg. 7. Contains peptone from milk and lecithin, which is typically derived from soy or egg. 8. Possibly due to the presence of aryl sulfonate complex in the neutralizing buffer. 9. Some suppliers of Lethen broth specify refrigerated storage. 10. D/E shows pH instability with ambient storage.



Innovative sample collection devices
that combine thoughtful design
with advanced microbiology

www.worldbioproducts.com

(toll free) 877-260-6441 / (international) +1-425-242-4153

info@worldbioproducts.net

EZ Reach™ Sponge Samplers

Ideal for collecting samples without touching the sponge. The twist-off handle holds the sponge securely while sampling, but is easy to remove once sample collection is completed. Now available with 4X and 8X larger sponges for sampling larger surfaces.



EZ Reach



EZ Reach 4X



EZ Reach 8X

| EZ Reach™ polyurethane 100/case | Item # |
|---|---------------------|
| HiCap™ Neutralizing Broth 10 ml, 24 oz bag | EZ-10HC-PUR |
| HiCap™ Neutralizing Broth 10 ml, 24 oz w/gloves | EZ-10HC-PUR-G |
| HiCap™ Neutralizing Broth 10 ml, 18 oz bag | EZ18FR-10HC-PUR |
| HiCap™ Neutralizing Broth 10ml, 18 oz w/gloves | EZ18FR-10HC-PUR-G |
| D/E Neutralizing Broth 10 ml, 24 oz bag | EZ-10DE-PUR* |
| Lethen Broth 10 ml, 24 oz bag | EZ-10LET-PUR |
| Lethen Broth 10 ml, 18 oz bag | EZ18FR-10LET-PUR |
| Neutralizing Buffer 10 ml, 24 oz bag | EZ-10NB-PUR |
| Neutralizing Buffer 10 ml, 24 oz bag w/gloves | EZ-10NB-PUR-G |
| Neutralizing Buffer 20 ml, 24 oz bag | EZ-20NB-PUR |
| Neutralizing Buffer 10 ml, 18 oz bag | EZ18FR-10NB-PUR |
| Neutralizing Buffer 10 ml, 18 oz bag w/gloves | EZ18FR-10NB-PUR-G |
| Buffered Peptone Water 10 ml, 18 oz bag | EZ18FR-10BPW-PUR |
| Dry polyurethane sponge, 24 oz bag | EZ-DRY-PUR |

* Listed in FDA BAM Chapter 10 procedures for *Listeria monocytogenes*

| EZ Reach™ cellulose 100/case | Item # |
|---|----------------|
| Lethen Broth 10 ml, 24 oz bag | EZ-10LET-CELL |
| Neutralizing Buffer 10 ml, 24 oz bag | EZ-10NB-CELL |
| Neutralizing Buffer 10 ml, 24 oz bag w/gloves | EZ-10NB-CELL-G |
| Buffered Peptone Water 10 ml, 24 oz bag | EZ-10BPW-CELL |
| Buffered Peptone Water 25 ml, 24 oz bag | EZ-25BPW-CELL |



EZ Reach™ Split-Sampler

Easily separate a single sample into two distinct samples without the risk of incidental contamination or compromising sensitivity.

| EZ Reach™ Split-Samper 60/case | Item # |
|---------------------------------------|-----------------|
| HiCap™ Neutralizing Broth 20 ml | EZ-SP-20HC-PUR |
| Lethen Broth 20 ml | EZ-SP-20LET-PUR |

| EZ Reach™ 4X polyurethane 50/case | Item # |
|---|----------------|
| Double Strength Skim Milk, 40 ml, 6x13" bag | EZ4-40DSSM-PUR |
| HiCap™ Neutralizing Broth 40 ml, 6x13" bag | EZ4-40HC-PUR |

| EZ Reach™ 8X polyurethane 30/case | Item # |
|--|--------------|
| HiCap™ Neutralizing Broth 80 ml, 6x13" bag | EZ8-80HC-PUR |

SampleRight™ Sponge Sampler



Pre-hydrated high density PUR-polyurethane sponge is easy to manipulate and resists tearing and flaking, making it ideal for aggressively sampling rough surfaces. Available with and without gloves.

| SampleRight™ polyurethane 100/case | Item # |
|--|--------------------|
| HiCap™ Neutralizing Broth 10 ml, 18 oz bag | SR18-10HC-HDPUR |
| Lethen Broth 10 ml, 18 oz bag w/gloves | SR18-10LET-HDPUR-G |
| Neutralizing Buffer 10 ml, 24 oz bag w/gloves | SR-10NB-HDPUR-G |
| Buffered Peptone Water 20 ml, 18 oz bag w/gloves | SR18-20BPW-HDPUR-G |
| Buffered Peptone Water 25 ml, 18 oz bag | SR18-25BPW-HDPUR |

| SampleRight™ cellulose 100/case | Item # |
|---|--------------|
| HiCap™ Neutralizing Broth 10 ml, 18 oz bag w/gloves | SR18-10HC-G |
| Lethen Broth 10 ml, 24 oz bag | SR-10LET |
| Lethen Broth 10 ml, 24 oz bag w/gloves | SR-10LET-G |
| Neutralizing Buffer 10 ml, 24 oz bag | SR-10NB |
| Neutralizing Buffer 10 ml, 24 oz bag w/gloves | SR-10NB-G |
| Neutralizing Buffer 10 ml, 18 oz bag w/gloves | SR18-10NB-G |
| Buffered Peptone Water 10 ml, 24 oz w/gloves | SR-10BPW-G |
| Buffered Peptone Water 10 ml, 18 oz bag | SR18-10BPW |
| Buffered Peptone Water 10 ml, 18 oz w/gloves | SR18-10BPW-G |
| Dry cellulose, 24 oz bag | SR-DRY |
| Dry cellulose, 24 oz bag w/gloves | SR-DRY-G |
| Dry cellulose, 18 oz bag | SR18-DRY |
| Dry cellulose, 18 oz bag w/gloves | SR18-DRY-G |

PUR-Blue™ Swab Sampler

US Patent 9,027,420



Compressible and rugged PUR-polyurethane swab tip allows for aggressive sampling of small to large surface areas. Ideal for both pathogen detection and plate counts.

| PUR-Blue™ Swab | 100/case | Item # |
|--|----------|------------|
| HiCap™ Neutralizing Broth 1 ml, small swab | | BLU-1HC-S |
| HiCap™ Neutralizing Broth 1.5 ml | | BLU-HC-P |
| HiCap™ Neutralizing Broth 5 ml | | BLU-5HC |
| HiCap™ Neutralizing Broth 10 ml | | BLU-10HC |
| D/E Neutralizing Broth 1.5 ml | | BLU-DE-P |
| Lethen Broth 1 ml, small swab | | BLU-1LET-S |
| Lethen Broth 1.5 ml | | BLU-LET-P |
| Lethen Broth 5 ml | | BLU-5LET |
| Lethen Broth 10 ml | | BLU-10LET |
| Neutralizing Buffer 4 ml | | BLU-4NB |
| Neutralizing Buffer 5 ml | | BLU-5NB |
| Neutralizing Buffer 10 ml | | BLU-10NB |
| Dry sterile swab | | BLU-DRY |



US Patent 9,027,420

PUR-Blue™ DUO Swab Sampler

Collection and enrichment of pathogens with a single device. One tube contains a PUR-polyurethane swab with a neutralizing media. The second tube contains a ready-to-use enrichment broth for *Listeria* or *Salmonella*.

| PUR-Blue™ DUO Swab | 100/case | Item # |
|---|----------|------------|
| HiCap™ / Demi-Fraser Broth 9 ml | | DUO-HC9DFB |
| HiCap™ / Buffered Peptone Water 9 ml | | DUO-HC9BPW |
| D/E Neutralizing / Demi-Fraser Broth 9 ml | | DUO-DE9DFB |
| D/E Neutralizing / Buffered Peptone Water 9ml | | DUO-DE9BPW |



Veriswab™ Swab Sampler

The ideal swab for collecting samples from small areas with limited access such as cracks, crevices, and areas with small openings.

| Veriswab™ Sampler | 100/case | Item # |
|--------------------------------|----------|----------|
| HiCap™ Neutralizing Broth 1 ml | | VS-1HC |
| Neutralizing Buffer 4 ml | | VS-4NB |
| Neutralizing Buffer 10 ml | | VS-10NB |
| Buffered Peptone Water 10 ml | | VS-10BPW |
| Lethen Broth 1 ml | | VS-1LET |
| Lethen Broth 4 ml | | VS-4LET |
| Lethen Broth 10 ml | | VS-10LET |

Adapters & Extension Poles

Reach further with extension poles and adapters made specifically for EZ Reach sponges and PUR-Blue swabs.



| Adapters & Extension Poles | Item # |
|----------------------------------|----------------|
| EZ Reach™ Sponge Adapter, 1 unit | EZ-ADAPT |
| PUR-Blue™ Swab Adapter, 1 unit | BLU-ADAPT |
| Extension Pole 4 ft, 1 unit | EXT POLE 4-FT |
| Extension Pole 8 ft, 1 unit | EXT POLE 8-FT |
| Extension Pole 12 ft, 1 unit | EXT POLE 12-FT |

Dividable Grid Container

Dividable Grid Containers provide a convenient and secure way to handle, transfer, and process microbiological samples in wire closure samples bags.



| Dividable Grid Container | Item # |
|--------------------------------|------------------|
| Blue container, 1 unit each | DG-CONTAINER |
| Grey long divider, 6 per pack | DG-DIVIDER-LONG |
| Grey short divider, 6 per pack | DG-DIVIDER-SHORT |

NovaLock™ Dilution Bottles

The patented lockdown tab technology prevents leakage during transport and allows for easy aseptic opening. No shrink wrap to remove and no strips to pull. Color-coded tamper evident labels identify the type and volume of diluent.



US Patent 8,590,735 B2

| NovaLock™ Dilution Bottles | 60/case | Item # |
|-----------------------------------|---------|-----------|
| Butterfield's Phosphate Buffer | 90 ml | NLD-90BFD |
| Butterfield's Phosphate Buffer | 99 ml | NLD-99BFD |
| Buffered Peptone Water (ISO) | 90 ml | NLD-90BPW |
| Buffered Peptone Water (ISO) | 99 ml | NLD-99BPW |
| Peptone Water | 90 ml | NLD-90PW |
| Peptone Water | 99 ml | NLD-99PW |
| Demi-Fraser Broth | 90 ml | NLD-90DFB |
| Phosphate Buffer + MgCl | 99 ml | NLD-99PHB |

Pull String Sampler

Designed to collect samples from poultry and other livestock housing facilities. Packed in a truly sterile, non-perforated sample bag for accurate results.



| Pull String Sampler | 100/case | Item # |
|----------------------------|--------------------|----------------|
| Double Strength Skim Milk | 10 ml polyurethane | PS-10DSSM-PUR |
| Double Strength Skim Milk | 10 ml gauze | PS-10DSSM-GAUZ |

Sample Bags

Complete line of sterile Whirl-Pak® sample bags is available, including some of the most popular items listed below.

| Whirl-Pak® sample bags | Item # |
|---|-------------------|
| Whirl-Pak® Bags, 18 oz, 4.5"x9" | 500/case NSB-1020 |
| Write-On Bags, 18 oz, 4.5"x9" | 500/case NSB-1065 |
| Write-On Bags, 24 oz, 6"x9" | 500/case NSB-1297 |
| Blender Bags w/filter, 7 oz, 3.75"x7" | 250/case NSB-1385 |
| Blender Bags w/filter, 24 oz, 6"x9" | 250/case NSB-1348 |
| Blender Bags w/filter, 55 oz, 7.5"x12" | 250/case NSB-1318 |
| Blender Bags, Write-On, 55 oz, 7.5"x12" | 500/case NSB-1195 |
| Blender Bags w/filter, 92 oz, 10"x15" | 100/case NSB-1488 |

FlipRight™ Prefilled Vials

The lockdown tab with the unique lever design makes FlipRight one of the most secure and easy to open tubes or vials available. Designed to be easily opened with either one or two hands.



US Patent 8,590,735 B2

| FlipRight™ Prefilled Vials | 100/case | Item # |
|-----------------------------------|----------|-----------|
| Butterfield's Phosphate Buffer | 9 ml | FRV-9BFD |
| Butterfield's Phosphate Buffer | 10 ml | FRV-10BFD |
| Buffered Peptone Water | 9 ml | FRV-9BPW |
| Buffered Peptone Water | 10 ml | FRV-10BPW |
| Lethen Broth | 9 ml | FRV-9LET |
| Lethen Broth | 10 ml | FRV-10LET |
| D/E Neutralizing Broth | 9 ml | FRV-9DE |

Boot Swab

Boot swabs are stretchable, sterile fabric boot covers with an integral elastic band designed to easily slide over any shoe or boot and remain securely in place for effortless collection of samples from the floor surface.



| Boot Swab | 100/case | Item # |
|------------------------------------|----------|--------------|
| Double Strength Skim Milk, 1 swab | | BOOT-DSSM-1B |
| Double Strength Skim Milk, 2 swabs | | BOOT-DSSM-2B |

Carcass Sampling

| Cattle/Swine Carcass Sampling Kit | Item # |
|--|----------------|
| (SR-DRY-G) dry cellulose sponge in a 24 oz sample bag with gloves, (CS-25BFD) 25 ml Butterfields Phosphate Buffer, and (TP-10x10-PLAIN) 100cm² plastic template, 15 each/kit | CSKIT-BFD |
| Carcass Sampling Components | Item # |
| Dry cellulose sponge w/glove 24oz bag, 100/case | SR-DRY-G |
| Carcass Sampling Bottle, Butterfield's Phosphate Buffer, 25 ml, 36/case | CS-25BFD |
| Turkey Template, 50 cm², sterile, 50/case | TP-5X10-PLAIN |
| Cattle Swine Template, 100 cm², sterile, 50/case | TP-10X10-PLAIN |
| Poultry Rinse Bag, 15x20 in, 2 mil polyethylene, sterile, 50/case | NSB-1319 |
| Glove Packs, blue polyethylene, 100 pair/case | GP-BLUE-PE |